

CITY OF LAVON, TEXAS
ORDINANCE NO. 2018-01-01

Boundary Map

AN ORDINANCE OF THE CITY COUNCIL OF THE CITY OF LAVON, TEXAS ADOPTING THE CITY BOUNDARY MAP; PROVIDING FOR SEVERABILITY AND REPEALER CLAUSES; PROVIDING FOR PUBLICATION; AND PROVIDING FOR AN EFFECTIVE DATE.

WHEREAS, Chapter 41 of the Texas Local Government Code requires that each municipality prepare and maintain a map that shows the boundaries of the municipality and of its extraterritorial jurisdiction; and

WHEREAS, the City Council has reviewed the City's boundary map, attached hereto as Exhibit "A", and finds and determines that the map accurately depicts the boundaries of the city and of its extraterritorial jurisdiction;

NOW THEREFORE, BE IT ORDAINED BY THE CITY COUNCIL OF THE CITY OF LAVON, TEXAS, THAT:

SECTION 1. ADOPTION OF THE AMENDED CITY MAP

The Boundary Map of the City of Lavon, Collin County, Texas designating the boundaries of the city and of its extraterritorial jurisdiction attached hereto as Exhibit "A" is hereby adopted. Pursuant to Section 41.001 of the Texas Local Government Code the City Council directs that a copy of the Official Map shall be maintained in the City Secretary's Office.

SECTION 2. SEVERABILITY CLAUSE

In the event any clause, phrase, provision, sentence, or any part of this Ordinance or the application of the same to any person or circumstances shall for any reason be adjudged invalid or held unconstitutional by a court of competent jurisdiction, it shall not affect, impair, or invalidate this Ordinance as a whole or any part or provisions hereof other than the part declared to be invalid or unconstitutional; and the City Council of the City of Lavon, declares that it would have passed each and every part of the same notwithstanding the omission of any such part thus declared to be invalid or unconstitutional, whether there be one or more parts.

SECTION 3. REPEALER CLAUSE

All ordinances or parts of an ordinance inconsistent or in conflict herewith are, to the extent of such inconsistency or conflict, hereby repealed. All other provisions of the ordinances of the City which are not in conflict with the provisions of this Ordinance shall remain in full force and effect.

SECTION 4. OPEN MEETING

It is hereby officially found and determined that all notice required by law has been given and notice of this Ordinance was posted and the Ordinance passed in accordance with the Open Meeting Act.

SECTION 5. PUBLICATION

The City Secretary is hereby directed to publish notice of this Ordinance in accordance with applicable laws.

SECTION 6. EFFECTIVE DATE.

This Ordinance shall take effect immediately from and after its passage and the publication of the caption, as the law in such cases provides.

DULY PASSED and APPROVED by the City Council of the City of Lavon, Texas, on the 2nd day of January 2018.



Vicki Sanson, Mayor Pro Tem

ATTEST:



Kim Dobbs, City Administrator | City Secretary



CITY OF LAVON, TEXAS
ORDINANCE NO. 2018-01-01

EXHIBIT A
BOUNDARY MAP

City of Lavon Boundaries Map December 2017

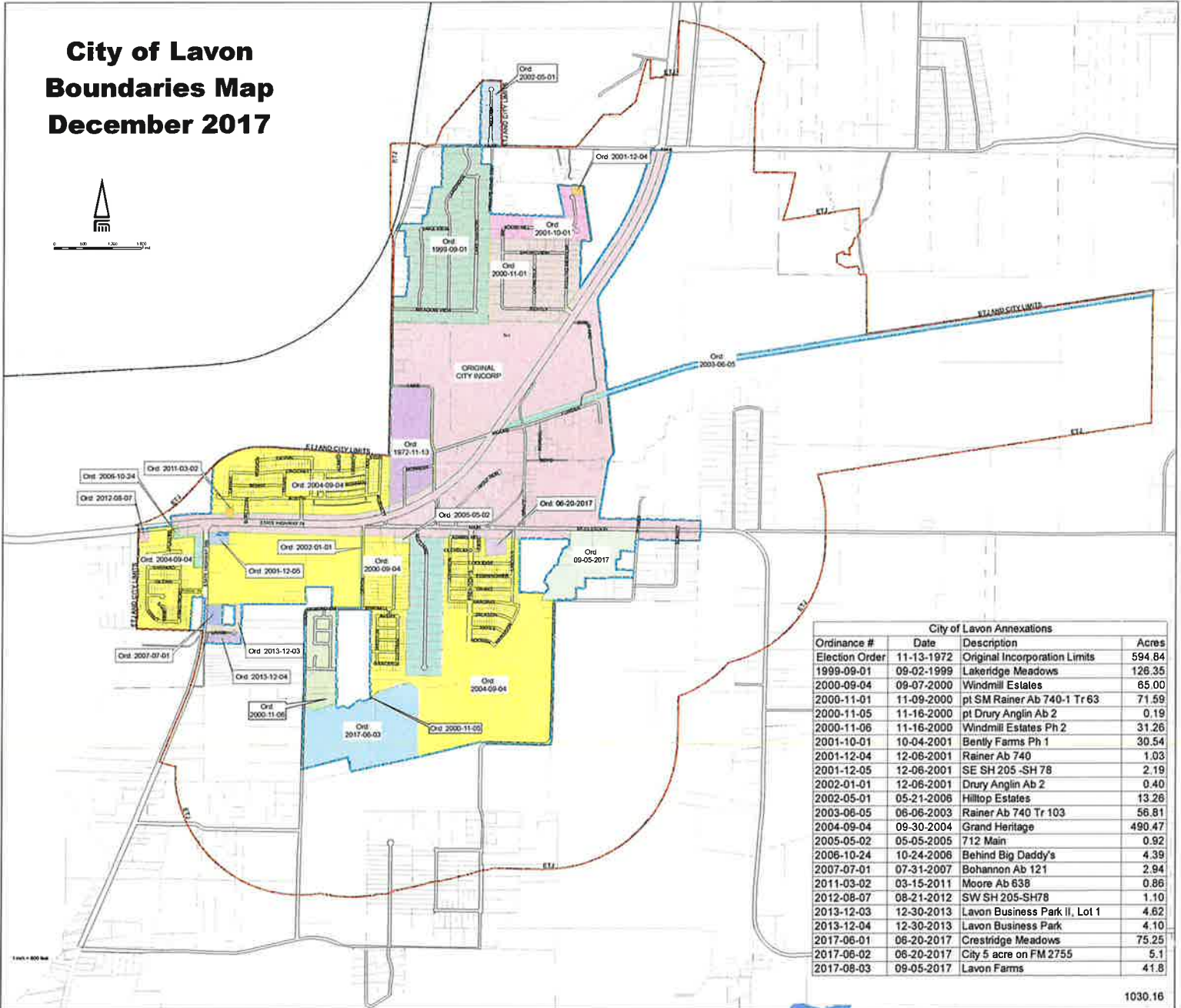

City of Lavon Annexations			
Ordinance #	Date	Description	Acres
Election Order	11-13-1972	Original Incorporation Limits	594.84
1999-09-01	09-02-1999	Lakeridge Meadows	126.35
2000-09-04	09-07-2000	Windmill Estates	65.00
2000-11-01	11-09-2000	pt SM Rainer Ab 740-1 Tr 63	71.59
2000-11-05	11-16-2000	pt Drury Anglin Ab 2	0.19
2000-11-06	11-16-2000	Windmill Estates Ph 2	31.26
2001-10-01	10-04-2001	Bently Farms Ph 1	30.54
2001-12-04	12-06-2001	Rainer Ab 740	1.03
2001-12-05	12-06-2001	SE SH 205 -SH 78	2.19
2002-01-01	12-06-2001	Drury Anglin Ab 2	0.40
2002-05-01	05-21-2006	Hilltop Estates	13.26
2003-06-05	06-06-2003	Rainer Ab 740 Tr 103	56.81
2004-09-04	09-30-2004	Grand Heritage	490.47
2005-05-02	05-05-2005	712 Main	0.92
2006-10-24	10-24-2006	Behind Big Daddy's	4.39
2007-07-01	07-31-2007	Bohannon Ab 121	2.94
2011-03-02	03-15-2011	Moore Ab 638	0.86
2012-08-07	08-21-2012	SW SH 205-SH78	1.10
2013-12-03	12-30-2013	Lavon Business Park II, Lot 1	4.62
2013-12-04	12-30-2013	Lavon Business Park	4.10
2017-06-01	06-20-2017	Crestridge Meadows	75.25
2017-06-02	06-20-2017	City 5 acre on FM 2755	5.1
2017-08-03	09-05-2017	Lavon Farms	41.8